

H 220

Dimensions

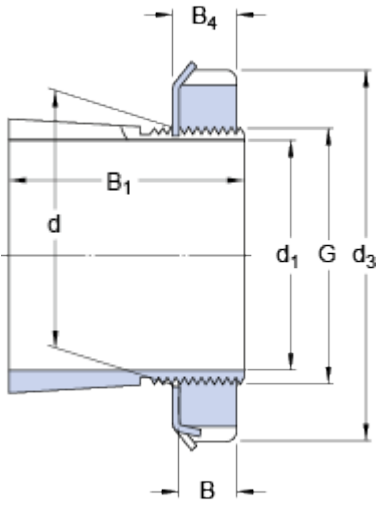

| | | |
|-------|---------|----|
| d_1 | 90 | mm |
| d | 100 | mm |
| d_3 | 130 | mm |
| B_1 | 58 | mm |
| B | 18 | mm |
| B_4 | 20 | mm |
| G | M 100x2 | |

Mass

Mass adapter sleeve assembly

1.4 kg

Appertaining products

Lock nut

KM 20

Locking device

MB 20

Appropriate products

Hydraulic nut

HMV 20 E